

# TWIST CURVED END CAP

*product set up instructions*

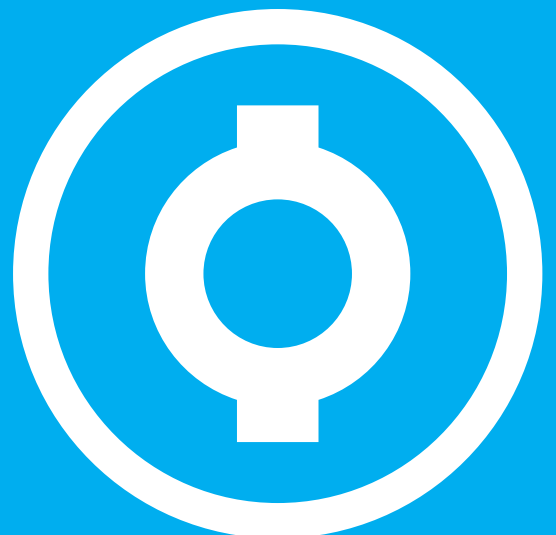

## Twist Curved End Cap Setup Instructions

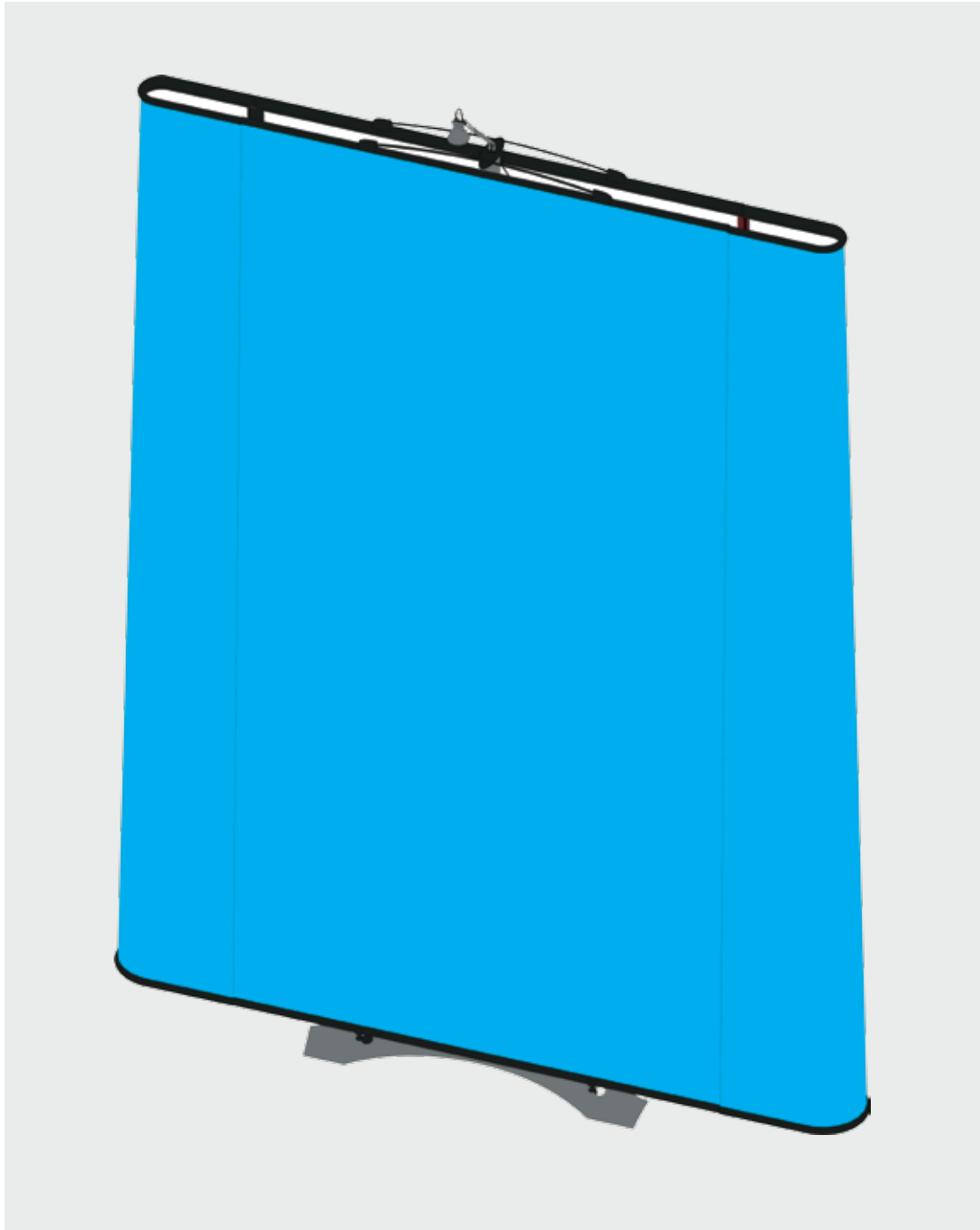

## Twist Curved End Cap Setup Instructions

### Items

6x magnetic bars, endcap graphic panel, complete double sided Twist stand.

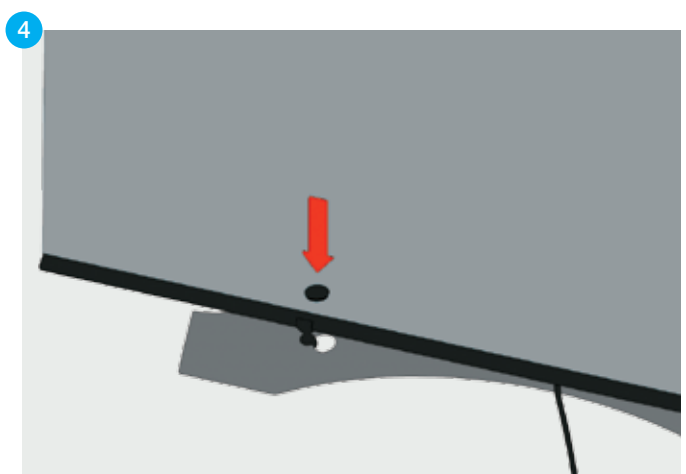
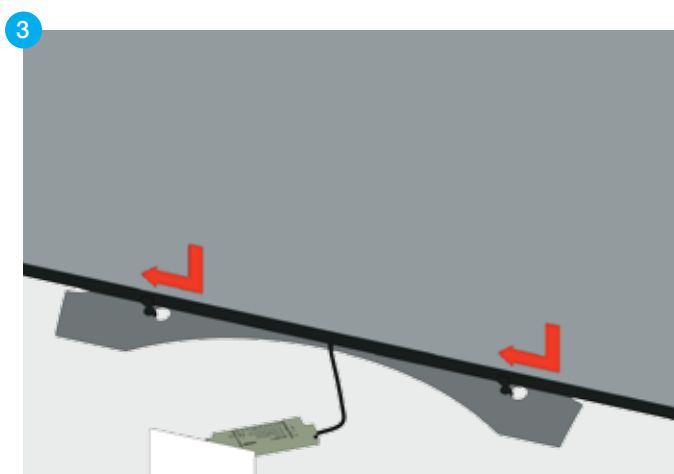
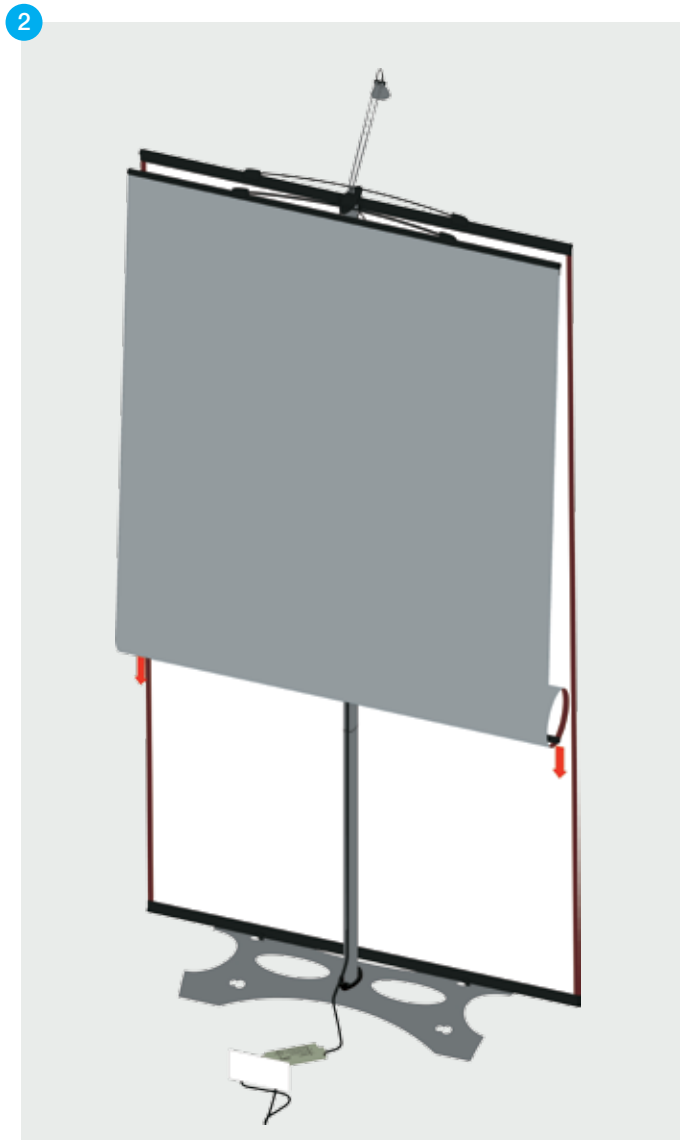
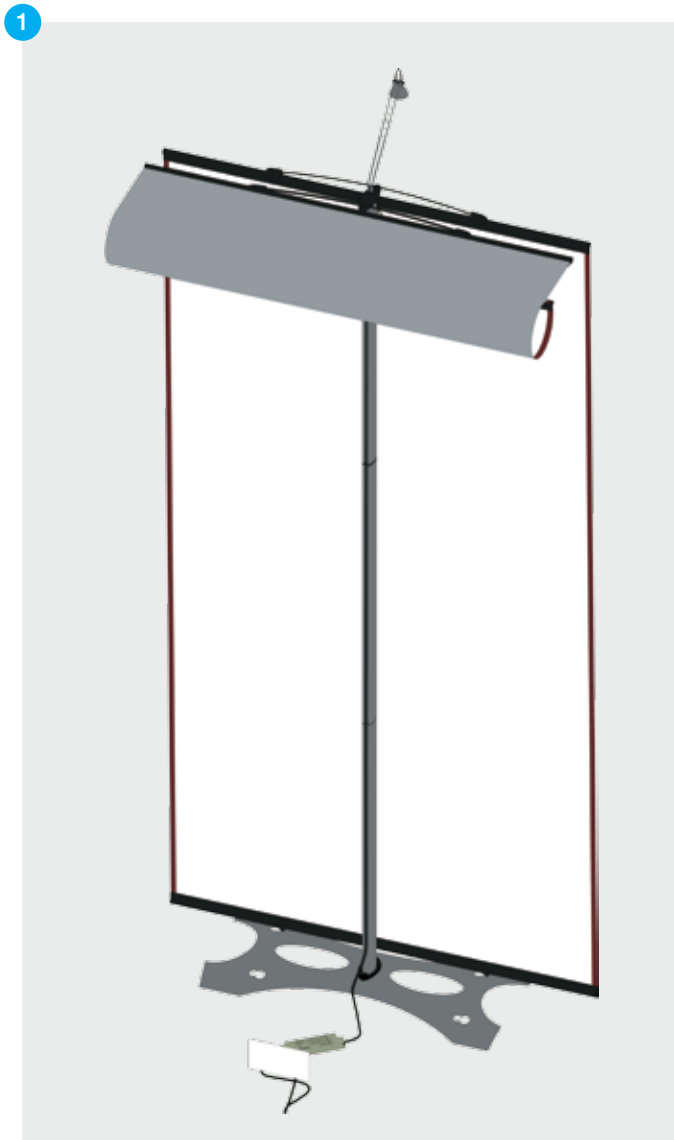

## Twist Curved End Cap Setup Instructions

Attach magnetic bars to Twist graphics first, leaving half of magnetic bar showing.

